

READ THESE INSTRUCTIONS CAREFULLY

1. You have been given this question paper and a separate answer sheet. The question paper contains 50 questions.
2. Do any necessary rough work in this paper.
3. When you have chosen your answer, mark it on the **ANSWER SHEET**, not in this question paper.

HOW TO USE THE ANSWER SHEET

4. Use an ordinary pencil only.
5. Make sure that you have written on the answer sheet

YOUR INDEX NUMBER

YOUR NAME

NAME OF YOUR SCHOOL

6. By drawing a **dark line** inside the correct numbered boxes mark your full Index Number (ie. School Code Number and the three-figure Candidate's Number) in the grid near the top of the answer sheet.
7. Do not make any marks outside the boxes.
8. Keep your answer sheet as clean as possible and **DO NOT FOLD IT**.
9. For each Questions 1 - 50, four answers are given. The answers are lettered **A, B, C, D** in each case only **ONE** of the four answers is correct. Choose the correct answer.
10. On the answer sheet show the correct answer by drawing a **dark line** inside the box in which the letter you have chosen is written.

Example

In the question booklet

19. What is the square of **0.25**?

A. 2.5

B. 0.0625

C. 0.0025

D. 0.625

The correct answer is **B**

19. [A] [B] [C] [D]

In the set of boxes numbered **19**, the box with letter **B** printed in it is marked

11. Your dark line **MUST BE** within the box.
12. For each question **ONLY ONE** box is to be marked in each set of four boxes.

This question paper consists of 8 printed pages

Email: info@pinpointpublishers.co.ke



Pinpoint Publishers
Always to the point

TURN OVER

1. What is seven million seven hundred and seven thousand and seven in symbols?
A. 7707007
B. 77707007
C. 7007707
D. 77007007
2. What is the place value of digit 7 after dividing 45.149 by 13?
A. Hundredths
B. Tenths
C. Thousandths
D. Tens
3. What is the value of

$$\frac{56 \div (36 - 29) + 52}{3 \times 4} ?$$

A. 5
B. 15.75
C. $15\frac{3}{4}$
D. 20
4. The population of a town in 2018 was 10500. In 2019, the population dropped to 8400. What was the percentage decrease?
A. 80%
B. 25%
C. 20%
D. 10%
5. A prize giving day was attended by 2640 people. The number of women was twice that of children and 20 more than that of men. How many men attended the prize giving day?
A. 532
B. 1064
C. 1084
D. 1044
6. Arrange the following fractions from the largest to the smallest.
 $\frac{3}{4}, \frac{1}{2}, \frac{5}{8}, \frac{4}{7}$
A. $\frac{1}{2}, \frac{4}{7}, \frac{5}{8}, \frac{3}{4}$
B. $\frac{5}{8}, \frac{4}{7}, \frac{3}{4}, \frac{1}{2}$
C. $\frac{1}{2}, \frac{3}{4}, \frac{4}{7}, \frac{5}{8}$
D. $\frac{3}{4}, \frac{5}{8}, \frac{4}{7}, \frac{1}{2}$
7. Three bells ring at intervals of 24 minutes, 30 minutes and 40 minutes respectively. If they rang together in the morning, after how long will they ring together again?
A. 2hrs
B. 120hrs
C. 40 minutes
D. 180minutes
8. What is the square root of $5\frac{1}{16}$?
A. $25\frac{1}{256}$
B. $3\frac{1}{4}$
C. $1\frac{1}{4}$
D. $2\frac{1}{4}$
9. A school received 60 cartons of biscuits. Each carton had 30 packets and each packet had 24 biscuits. If each pupil received 144 biscuits, how many pupils were in that school?
A. 144
B. 300
C. 43200
D. 12.5
10. What is the next number in the sequence below?
87, 99, 114, 132, 153, _____
A. 174
B. 179
C. 177
D. 167

11. In the figure below, PQ is parallel to RS while WX and YZ are straight lines.

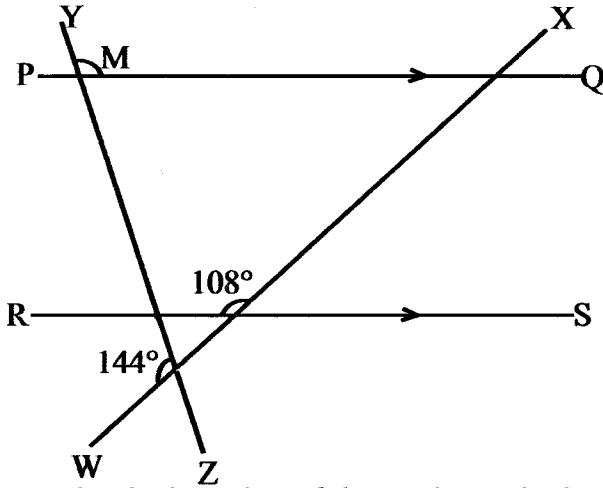

What is the value of the angle marked M in the diagram?

- A. 72°
 B. 36°
 C. 108°
 D. 144°
12. The marked price of a jacket is sh.1500. Ashley bought 3 jackets after getting a 12% discount on each jacket. How much did she pay for the jackets?
- A. Sh. 1320
 B. Sh. 180
 C. Sh. 540
 D. Sh. 3960
13. Owino had sh.30000. He shared it among his three children. The first one got $\frac{1}{5}$ of the money. The second received $\frac{1}{3}$ and the third received $\frac{1}{4}$ of the remainder. How much money was he left with?
- A. Sh. 10500
 B. Sh. 1600
 C. Sh. 8500
 D. Sh. 1400

14. The figure below represents a plot. It was fenced with three strands of wire. What length of wire was used?

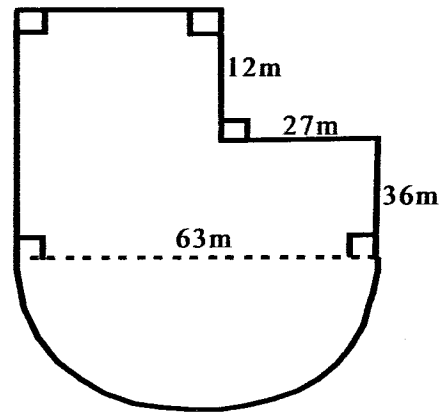

- A. 258m
 B. 774m
 C. 666m
 D. 222m
15. Six men working at the same rate can complete a task in 18 hours. How many more hours will it take 4 men working at the same rate?
- A. 27 hrs
 B. 9 hrs
 C. 18 hrs
 D. 108 hrs
16. Work out:
 $\frac{1.4 \times 0.036}{0.28 \times 2}$
- A. 0.9
 B. 9
 C. 0.009
 D. 0.09
17. The government released 20 tonnes of maize to feed the starving families. Each family received 25kg of maize. How many families were fed?
- A. 800
 B. 20000
 C. 500
 D. 0.8

18. A sales lady was paid a salary of sh.15000 plus 3% commission on goods sold. In a certain month, she sold goods worth sh. 200000. How much money did she earn that month?
- A. Sh. 21000
B. Sh. 600
C. Sh. 24000
D. Sh.18000

19. A welder made one open cylindrical container below. What is the area of the material used?

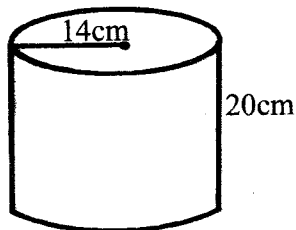

- A. 2376cm^2
B. 2992cm^2
C. 1760cm^2
D. 12320cm^2
20. A trader bought 40 litres of juice. He later packed it in bottles of 500ml and 300ml. If he packed equal number of bottles, how many bottles of 500ml capacity did he require?
- A. 50
B. 100
C. 25
D. 20

21. A meeting took 3 hours and 25 minutes. It ended at 2.55 p.m. What time had it started in 24hrs clock system?
- A. 11:30am
B. 1130h
C. 6.20pm
D. 1820h

22. The ratio of boy to girls in a school was 3:4. There were a total of 700 pupils. If the end of the year 40 girls left the school and 20 boys joined, what was the new ratio of boys to girls at the end of the year?
- A. 3:4
B. 7:11
C. 13:21
D. 8:9

23. Round off 187×55 to the nearest hundred.
- A. 10300
B. 10285
C. 10290
D. 10000

24. Construct triangle ABC in which $AB=6\text{cm}$, $BC = AC = 5.5\text{cm}$. Drop a perpendicular from C to meet AB at D. Measure CD.

A. 5cm

B. 8cm

C. 3cm

D. 4.6cm

25. A motorist started his journey at 11:20 a.m and drove for 3hour at a speed of 80km/h. He stopped for 30 minutes and then continued with the remaining journey of 120km at a speed of 60km/h. At what time did he arrive?
- A. 2.50am
B. 4.50p.m
C. 4.20pm
D. 4.50am

26. What is the volume of the figure below?

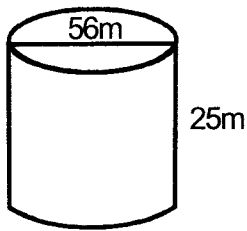

- A. 6160m^2
B. 61600m^3
C. 4400m^3
D. 6864m^3
27. Mueni deposited sh. 50000 in a bank that paid a simple interest at the rate of 8% per year. How much interest did she get at the end of 3 years?
- A. Sh. 62000
B. Sh. 4000
C. Sh. 12000
D. Sh. 1200000

28. What is the square root of 23.04?
- A. 0.48
B. 0.048
C. 4.8
D. 48

29. What is the value of $1\frac{5}{12} - \frac{7}{8}$ of $2 \div 1\frac{3}{4}$?
- A. $\frac{5}{12}$
B. $\frac{7}{12}$
C. $\frac{15}{12}$
D. $\frac{13}{24}$

5

30. A section of a river is 4.5km long. It is represented by 9cm on a map. What is the scale used?
- A. 1:50000
B. 9:45
C. 1:500000
D. 1:450000

31. A rectangular tank measuring 1.4m by 1.2 by 0.8m was filled with water. How many litres did the tank hold?
- A. 1.344
B. 13.44
C. 134400
D. 1344

32. The table below shows distances in kilometres between five towns J,K,L,M and N.

J				
120	K			
110	130	L		
220	240	110	M	
400	360	300	240	N

Kuria travelled from town J to N via L. What distance did he cover?

- A. 240km
B. 410km
C. 490km
D. 400km
33. The height of 7 boys is 154cm, 126cm, 138cm, 145cm, 154cm, 152cm and 146cm. What is the sum of their mean and median height?
- A. 300
B. 145
C. 291
D. 299

34. What is the value of y in

$$4(2y + 3) - 5 = 33?$$

$$\frac{1}{4}$$

B. 26

C. 3

D. 5

35. Express $2\frac{1}{2}\%$ as a fraction.

A. $\frac{5}{2}$

B. $\frac{1}{20}$

C. $\frac{1}{40}$

D. $\frac{3}{40}$

36. The marked price of a woofer was sh.5000. Njeri bought it on hire purchase by paying deposit of sh. 2000 and the rest in 5 equal monthly instalments of sh. 800 each. How much more money did she pay had she bought it in cash?

A. Sh. 6000

B. Sh. 3000

C. Sh. 2000

D. Sh. 1000

37. The figure below shows a rectangular plot with a path 2m wide round it. What is the area covered by the path?

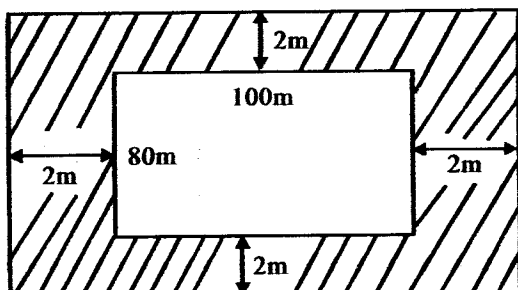

A. $16m^2$

B. $736m^2$

C. $8000m^2$

D. $8736m^2$

38. The following are characteristics of a quadrilateral;

i) *Has one pair of parallel sides*

ii) *Diagonals bisect but not at right angles*

iii) *Diagonals are equal*

iv) *All angles are equal at 90°*

v) *All sides are equal*

Which properties belong to a rectangle?

A. ii, iii, iv

B. i, iii, v

C. ii, iii, iv

D. iii, iv, v

39. The perimeter of an equilateral triangle is 48cm. If the height is 9cm, what is the area of the triangle?

A. $432cm^2$

B. $144cm^2$

C. $72cm^2$

D. $216cm^2$

40. Which of the following numbers is divisible by 11?

A. 17683

B. 28953

C. 95765

D. 74360

41. Increase 800 in the ratio 5:4.

A. 640

B. 900

C. 1200

D. 1000

42. In a meeting, there were 720 people. The number of men was 120 and the number of women was $\frac{1}{3}$ that of children. If this information was presented in a pie chart, how many degrees would represent women?

- A. 75°
- B. 150°
- C. 100°
- D. 300°

43. What is the value of $\frac{b + 2a}{ac - b}$

when $a = 5$, $b = 10$ and $c = b - 4$?

- A. 2.2
- B. 1.1
- C. 2.5
- D. 1

44. What is the sum of the square of 24 and the square root of 1225?

- A. 576
- B. 611
- C. 541
- D. 840

45. What is the area of the figure below?

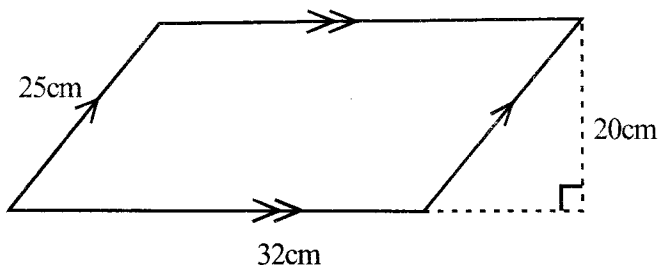

- A. 800cm^2
- B. 640cm^2
- C. 320cm^2
- D. 940cm^2

46. The circumference of a wheel is 154cm. What is the radius of the wheel?

- A. 49cm
- B. 14cm
- C. 28cm
- D. 24.5cm

47. Onyiro bought the following items from a shop;

3 litres of cooking oil for sh.980

2 $\frac{1}{2}$ kg of meat @ sh.400

$\frac{1}{4}$ kg packet of tea leaves @ sh.360

1 bar of soap at sh.180

How much did he pay for the items?

- A. Sh. 2520
- B. Sh. 1920
- C. Sh. 2250
- D. Sh. 4210

48. James and Michael shared some money in the ratio 7:9. If James received sh. 4000 less than Michael. How much money did they have altogether?

- A. Sh. 14000
- B. Sh. 18000
- C. Sh. 16000
- D. Sh. 32000

49. Change 108km/h into m/s.

- A. 20m/s
- B. 30m/s
- C. 388.8m/s
- D. 15m/s

50. The graph below shows a journey from A to B.

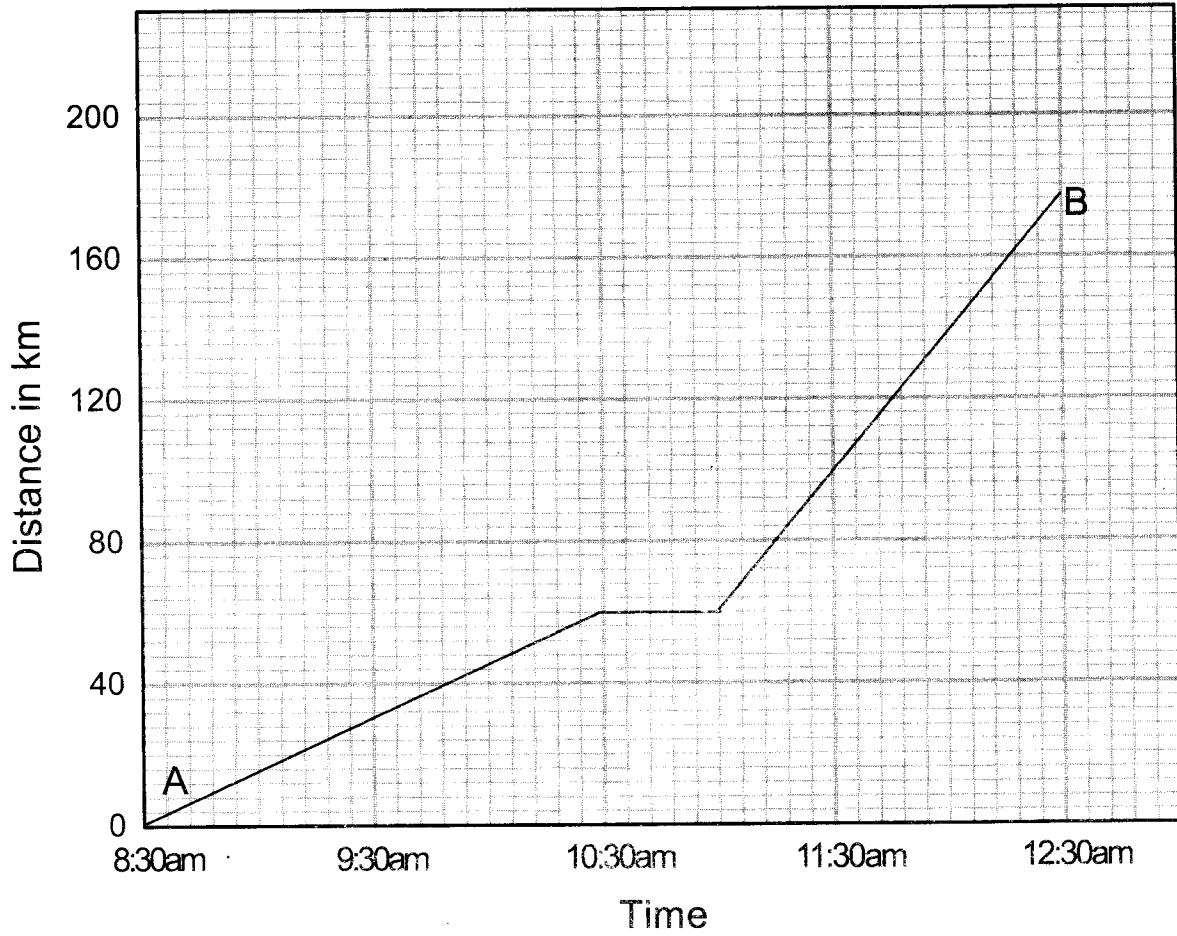

What was the average speed for the whole journey?

- A. 50km/h
- B. 60km/h
- C. 45km/h
- D. 80km/h